

Po.	P/N	DESCRIPTION	DESCRIZIONE	DESCRIPTION	DESCRIPTION	BEZEICHNUNG
1	01006926	DECAL	DECAL	DECAL	DECAL	Decal
2	10200008	YOKE SCREW 9/16"	VOLANTINO 9/16"	VOLANTINO 9/16"	VIS ETRIER 9/16"	Flugelschraube 9/16"
3	10715157	YOKE 9/16"	STAFFA 9/16"	STAFFA 9/16"	ETRIER 9/16"	Anschlußbügel
4	01073101	RETAINER	FERMA FILTRO	FERMA FILTRO	CLIP RETEN. FILTRE	Sicherung
5	01028109	FILTER	FILTRO	FILTRO	FILTRE	Filter
6	10715105	YOKE RETAIN.	BLOCCASTAFFA	BLOCCASTAFFA	RETEN. D'ETRIER	Bügelhalter
7	01050428	O-RING	FERMA FILTRO DIN 200	FERMA FILTRO DIN 200	JOINT TORIQUE	O-ring
8	10715122	FILTER RET. DIN 200	FERMA FILTRO DIN 300	FERMA FILTRO DIN 300	RET. FILTRE DIN 200	Sicherung DIN 200
**	10715124	FILTER RET. DIN 300	MOLLA	MOLLA	RESSORT	Sicherung DIN 300
9	01020179	SPRING	FERMO VOL. DIN 200	FERMO VOL. DIN 200	RET.VOLANT. DIN 200	Feder
10	10715121	NOB RET. DIN 200	FERMO VOL. DIN 300	FERMO VOL. DIN 300	RET.VOLANT. DIN 300	Sicherung DIN 200
**	10715123	NOB RET. DIN 300	VOLANTINO DIN 200	VOLANTINO DIN 200	VOLANT. DIN 200	Sicherung DIN 300
11	10105120	NOB, DIN 200	VOLANTINO DIN 300	VOLANTINO DIN 300	VOLANT. DIN 300	Anschlußschraube D200
**	10105122	NOB, DIN 300	RONDELLA	RONDELLA	RONDELLE	Anschlußschraube D300
12	01060502	WASHER	SELLA	SELLA	SELLE	Scheibe
13	10600111	SADDLE	O-RING	O-RING	JOINT TORIQUE	Auflagesattel
14	01050138	O-RING	TAPPO PROTEZIONE	TAPPO PROTEZIONE	PROTECT. ENTREE HP	O-ring
15	10101212	INLET PROTECTOR	TAPPO PROTEZIONE	TAPPO PROTEZIONE	PROTECT. ENTREE HP	Schutzkugel
15	10101211	INLET PROTECTOR	CAPPUCCIO	CAPPUCCIO	CAPUCHON	Schutzkugel
16	10705104	CAP	CAPPUCCIO	CAPPUCCIO	CAPUCHON	Capuze
17	10755109	DIAPHRAGM HOLDER	GHIERA REGOLAZ.	GHIERA REGOLAZ.	PROTECT. MEMBRANE	Membranschutzhülse
18	10755114	SPRING SCREW	MOLLA T.I.S.	MOLLA T.I.S.	RESSORT T.I.S.	Feder T.I.S.
19	01020209	SPRING T.I.S.	DISCO MOLLA	DISCO MOLLA	RONDELLE RESSORT	Membrandruckscheibe
20	10705123	DIAPHR. EXT. DISC	RONDELLA MEMBR.	RONDELLA MEMBR.	RONDELLE MEMBR.	Membrandruckscheibe
21	10705110	DIAPHRAGM RING	MEMBRANA	MEMBRANA	MEMBRANE	Membrandruckring
22	10705119	DIAPHRAGM	DISCO CENTRAT.	DISCO CENTRAT.	DISQUE	Membrane
23	01025200	DISC	INSERTO DISCO	INSERTO DISCO	SUPPORT	Scheibe
24	01025201	INSERT, DISC	ASTINA	ASTINA	POINTEAU	Kolbenteiler
25	10755112	DIAPHRAGM PIN	CORPO	CORPO	CORPS	Kolbennadel
26	10755101	BODY	TAPPO H.P.	TAPPO H.P.	BOUCH. SORTIE H.P.	Gehäuse
27	10715139	PLUG H.P.	PASTIGLIA	PASTIGLIA	CLAPET	Verschlußschraube
28	10755161	SEAT	PISTONCINO H.P.	PISTONCINO H.P.	CLAPET H.P.	Sitz
29	10755105	H.P. POPPET	BOCCOLA GUIDA	BOCCOLA GUIDA	GUIDE	Hochdruckkolben
30	10755106	SLEEVE	MOLLA	MOLLA	RESSORT	Sitzhalter
31	01020228	SPRING	RONDELLA	RONDELLA	RONDELLE	Feder
32	01060107	WASHER	O-RING	O-RING	JOINT TORIQUE	Scheibe
33	01050117	O-RING	BOCCOLA O-RING	BOCCOLA O-RING	ANNEAU JOINT TOR.	O-ring
34	10755104	RING	O-RING	O-RING	JOINT TORIQUE	Ring
35	01050145	O-RING	BALANCE CHAMBER	CAMERA BILANC.	CHAMBRE COMPENS.	O-ring
36	10755102	BALANCE CHAMBER	ASPIRATOR	ASPIRATOR	CONVOGIATORE	HP Balancekammer
37	01065010	ASPIRATOR	SWIVEL RETAINER	SWIVEL RETAINER	FERMO ANELLO GIREV.	O-ring
38	01050164	O-RING	WASHER	WASHER	RONDELLA	Sattelschraube
39	10500104	SWIVEL RETAINER	SWIVEL HOLDER	SWIVEL HOLDER	SUPP. ANELLO GIREV.	Scheibe
40	01060500	WASHER	O-RING	O-RING	ANELLO GIREV.	Schwennkopffalter
41	10755103	SWIVEL HOLDER	FLUG L.P.	FLUG L.P.	TAPPO B.P.	O-ring
42	10650162	O-RING	SOFT CAP	SOFT CAP	CAPPUCCIO MORBIDO	Schwennkopf
43	10715116	SWIVEL	WASHER L.P.	WASHER L.P.	RONDELLA B.P.	O-ring
44	01050132	O-RING	WASHER H.P.	WASHER H.P.	RONDELLA H.P.	O-ring
45	10715104	FLUG L.P.	WASHER	WASHER	RONDELLA	Verschlußschraube ND
46	10700108	SOFT CAP	O-RING	O-RING	JOINT TORIQUE	Capuze
47	01060609	WASHER L.P.	O-RING	O-RING	JOINT TORIQUE	Scheibe ND
48	01060608	WASHER H.P.	O-RING	O-RING	JOINT TORIQUE	Scheibe HP
49	01060153	WASHER	O-RING	O-RING	JOINT TORIQUE	Scheibe
50	01050347	O-RING	O-RING	O-RING	JOINT TORIQUE	O-ring

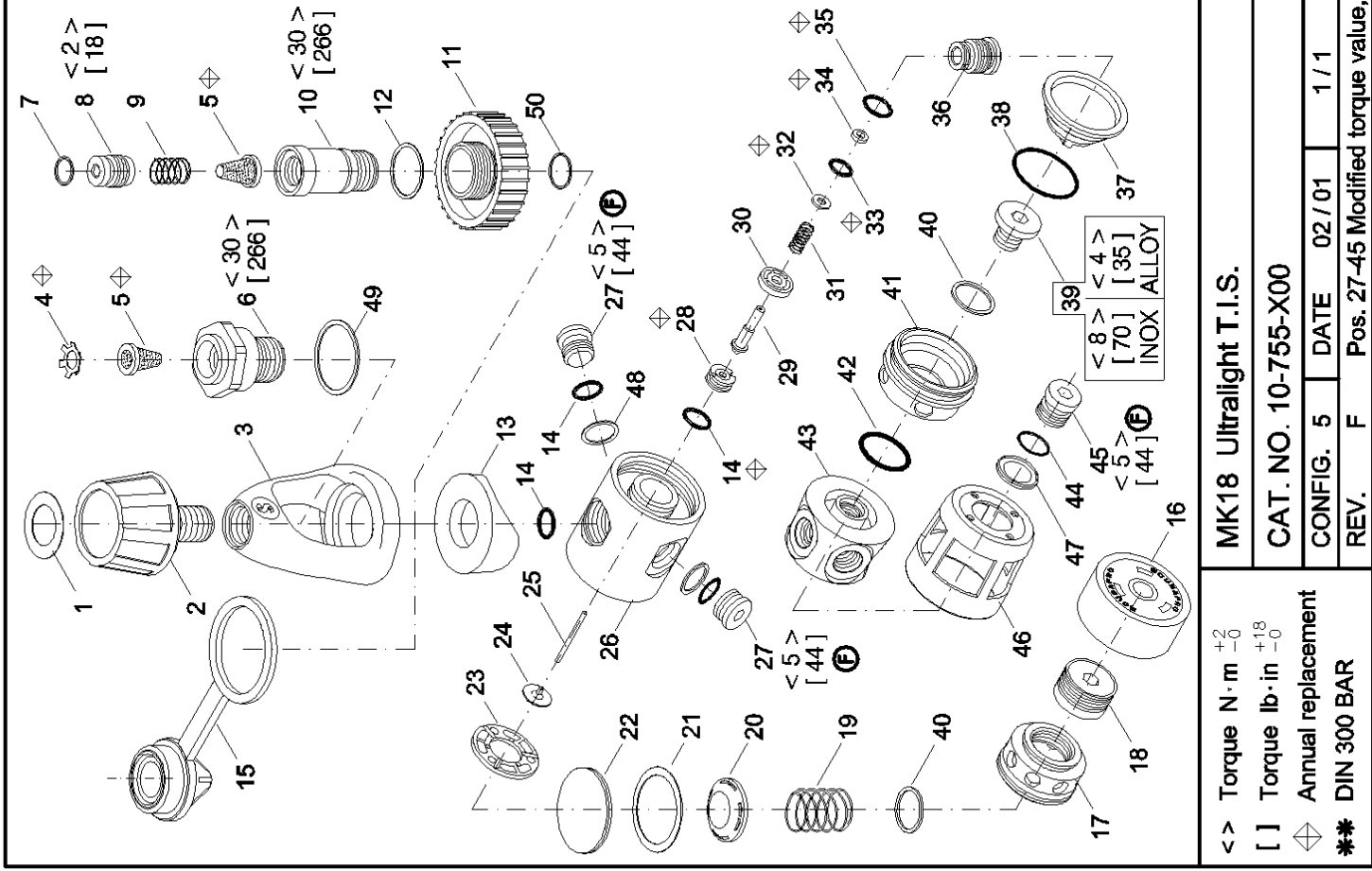

**MK18 UltraLight T.I.S.**  
**CAT. NO. 10-755-X00**  
**CONFIG. 5**    **DATE 02/01**    **1/1**  
**REV. F**    **Pos. 27-45 Modified torque value, was <4> [35] - Pos. 50 Modified O-Ring type (was P/N 01050147)**    **CHECKED**

- < > Torque N · m <sup>+2</sup> -<sub>0</sub>
- [ ] Torque lb · in <sup>+18</sup> -<sub>0</sub>
- ◇ Annual replacement
- \*\* DIN 300 BAR