

Po.	P/N	DESCRIPTION	DESCRIZIONE	DESCRIPTION	DESCRIZIONE	DESCRIPTION	BEZEICHNUNG
1	01006928	DECAL	DECAL	DECAL	DECAL	DECAL	Decal
2	10200008	YOKE SCREW	VOLANTINO	VIS ETRIER	VOLANTINO	VIS ETRIER	Flugelschraube
3	10705157	YOKE 9/16"	STAFFA 9/16"	ETRIER 9/16"	STAFFA 9/16"	ETRIER 9/16"	Anschlußbügel
4	01073101	RETAINER	FILTRO	CLIP RETEN. FILTRE	FILTRO	CLIP RETEN. FILTRE	Sicherung
5	01028109	FILTER	YOKER RETAIN.	FILTRE	FILTRO	FILTRE	Filter
6	10103115	O-RING	O-RING	RETEN. D'ETRIER	BLOCCASTAFFA	RETEN. D'ETRIER	Bügelhalter
7	01050428	O-RING	O-RING	JOINT TORIQUE	O-RING	JOINT TORIQUE	O-ring
8	10400122	FILTER RET. 200B	FERMA FILTRO 200B	RET. FILTRE 200B	FERMA FILTRO 200B	RET. FILTRE 200B	Sicherung 200B
**	10400124	FILTER RET. 300B	FERMA FILTRO 300B	RET. FILTRE 300B	FERMA FILTRO 300B	RET. FILTRE 300B	Sicherung 300B
9	01020179	SPRING	MOLLA	RESSORT	MOLLA	RESSORT	Feder
10	10400125	KNOB RET. 200B	FERMO VOL. 200B	RET. VOLANT. 200B	FERMO VOL. 200B	RET. VOLANT. 200B	Sicherung 200B
**	10400126	KNOB RET. 300B	FERMO VOL. 300B	RET. VOLANT. 300B	FERMO VOL. 300B	RET. VOLANT. 300B	Sicherung 300B
**	10105120	KNOB, 200B	VOLANTINO 200B	VOLANT. 200B	VOLANTINO 200B	VOLANT. 200B	AnschlußBschraube 200
**	10105122	KNOB, 300B	VOLANTINO 300B	VOLANT. 300B	VOLANTINO 300B	VOLANT. 300B	AnschlußBschraube 300
12	01050347	O-RING	O-RING	JOINT TORIQUE	O-RING	JOINT TORIQUE	O-ring
13	10600111	SADDLE	SELLA	SELLE	SELLA	SELLE	Auflagesattel
14	01050138	O-RING	O-RING	JOINT TORIQUE	O-RING	JOINT TORIQUE	O-ring
15	10101212	INLET PROTECT.	TAPPO PROTEZ.	PROT. ENTREE HP	TAPPO PROTEZ.	PROT. ENTREE HP	Schutzkugel
16	10101211	INLET PROTECT.	TAPPO PROTEZ.	PROT. ENTREE HP	TAPPO PROTEZ.	PROT. ENTREE HP	Schutzkugel
17	10705104	CAP	CAPPuccio	CAPUCHON	CAPPuccio	CAPUCHON	Capuze
17	10705109	DIAPHR. HOLDER	CAPPUCCIO MEMBR.	PROTECT. MEMBR.	CAPPUCCIO MEMBR.	PROTECT. MEMBR.	Membranschutzkappe
18	10705114	SPRING SCREW	GHIERA REGOLAZ.	VIS REGL. RESSORT	GHIERA REGOLAZ.	VIS REGL. RESSORT	Einstellerschraube
19	01020209	SPRING T.I.S.	MOLLA T.I.S.	RESSORT T.I.S.	MOLLA T.I.S.	RESSORT T.I.S.	Feder T.I.S.
20	10705123	DIAPHR. DISC	DISCO MOLLA	DISQUE RESS.	DISCO MOLLA	DISQUE RESS.	Membrandruckscheibe
21	10705110	DIAPHR. RING	RONDELLA MEMBR.	RONDELLE MEMBR.	RONDELLA MEMBR.	RONDELLE MEMBR.	Membranhaltering
22	10705119	DIAPHRAGM	MEMBRANA	MEMBRANE	MEMBRANA	MEMBRANE	Membrane
23	01025200	DISC	DISCO CENTRAT.	DISQUE	DISCO CENTRAT.	DISQUE	Scheibe
24	01025201	INSERT.DISC	INSERTO DISCO	SUPPORT	INSERTO DISCO	SUPPORT	Kolbenteller
25	10755112	DIAPHR. PIN	ASTINA	POINTEAU	ASTINA	POINTEAU	Kolbennadel
26	10756101	BODY	CORPO	CORPS	CORPO	CORPS	Gehäuse
27	10101139	PLUG H.P.	TAPPO H.P.	BOUCH. SORTIE HP	TAPPO H.P.	BOUCH. SORTIE HP	VerschlußBschraube
28	10755161	SEAT	PASTIGLIA	CLAPET	PASTIGLIA	CLAPET	Sitz
29	10755105	H.P. POPPET	PISTONCINO H.P.	CLAPET H.P.	PISTONCINO H.P.	CLAPET H.P.	Hochdruckkolben
30	10755106	SLEEVE	BOCCOLA GUIDA	GUIDE	BOCCOLA GUIDA	GUIDE	Sitzhalter
31	01020228	SPRING	MOLLA	RESSORT	MOLLA	RESSORT	Feder
32	01060107	WASHER	RONDELLA	RONDELLE	RONDELLA	RONDELLE	Scheibe
33	01050117	O-RING	O-RING	JOINT TORIQUE	O-RING	JOINT TORIQUE	O-ring
34	10755104	RING	BOCCOLA O-RING	ANNEAU JOINT TOR.	BOCCOLA O-RING	ANNEAU JOINT TOR.	Ring
35	01050145	O-RING	O-RING	JOINT TORIQUE	O-RING	JOINT TORIQUE	O-ring
36	10756102	BAL. CHAMBER	CAMERA BILANC.	CHAMBRE COMP.	CAMERA BILANC.	CHAMBRE COMP.	HP Balancekammer
37	01065010	ASPIRATOR	CONVOGLIATORE		CONVOGLIATORE		
38	01050164	O-RING	O-RING	JOINT TORIQUE	O-RING	JOINT TORIQUE	O-ring
39	10500104	SWIVEL RETAIN.	FERMO ANELLO GIR.	VIS RET. EMERILL.	FERMO ANELLO GIR.	VIS RET. EMERILL.	Sattelschraube
40	101060500	WASHER	RONDELLA	RONDELLE	RONDELLA	RONDELLE	Scheibe
41	10756103	SWIVEL HOLDER	SUPP. ANELLO GIR.	SUPP. TOURELLE	SUPP. ANELLO GIR.	SUPP. TOURELLE	Schwenkkoopfhalter
42	01050162	O-RING	O-RING	JOINT TORIQUE	O-RING	JOINT TORIQUE	O-ring
43	10600118	SWIVEL	ANELLO GIREV.	TOURELLE	ANELLO GIREV.	TOURELLE	Schwenkkopf
44	01050132	O-RING	O-RING	JOINT TORIQUE	O-RING	JOINT TORIQUE	O-ring
45	10101104	PLUG L.P.	TAPPO B.P.	BOUCHON M.P.	TAPPO B.P.	BOUCHON M.P.	VerschlußBschraube ND

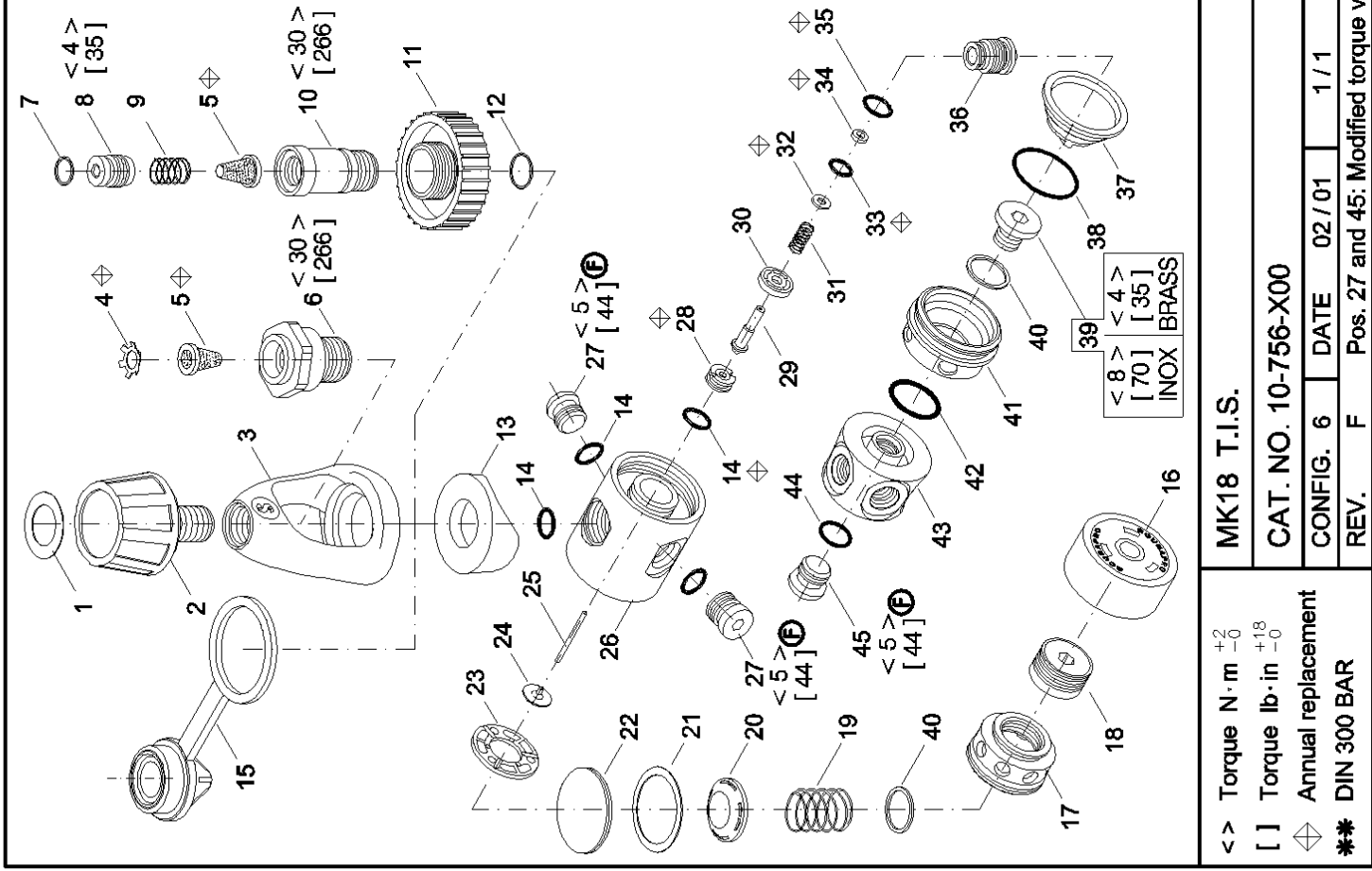

**MK18 T.I.S.**  
**CAT. NO. 10-756-X00**  
**CONFIG. 6**    **DATE 02/01**    **1/1**  
**REV. F**    **Pos. 27 and 45: Modified torque value (was 4 Nm)**  
**Checked**

- < > Torque N · m <sup>+6</sup> -0
- [ ] Torque lb · in <sup>+18</sup> -0
- ◇ Annual replacement
- \*\* DIN 300 BAR